

All replacement bases are:

- * Custom manufactured
- * Acrylic surface is .185" thickness
- * Reinforced with .375" thick high density foam
- * Integrated tile flanges for easy installation
- * Single threshold units
- * Available in **Almond**, **Biscuit**, **Gray**, **Sandbar** & **White**

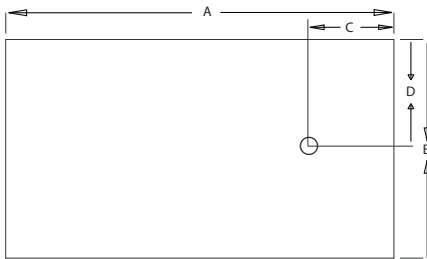

| Model | A | B | C and D |
|------------------------|-----------|-----------|--|
| SL-PL-(A/B/G/S/W)-SF | 30" - 60" | 28" - 36" | Center / Left / Right - Minimum 12" from studs |
| SL-PLXL-(A/B/G/S/W)-SF | 60" - 72" | 36" - 48" | Center (Call for left / right availability) |

REPLACEMENT SHOWER PAN

Is manufactured using a sheet of co-extruded DR/ABS (Durable Rubber Acrylic/Acrylantril Butadine Styrene). This sheet has a thickness of .185".

On the acrylic portion of the product, the DR is the top 15% of the sheet. It is pigmented a solid color than modified for a high impact surface. The ABS is the bottom 85% of the sheet. Like the DR, it is also pigmented. ABS is used because it is rigid, yet capable of flexibility.

The Replacement Shower Pan is reinforced with .375" thick high density foam.

- Integrated slip-resistant bottom
- Ansi code: Z124.1.2-2005 Approved
- Installed with mortar
- Thickness of acrylic sheet: .185"
- Consists of DR/ABS
 - DR: Durable Rubber Acrylic
 - ABS: Acrylantril Butadine Styrene

15% DR: Durable Rubber Acrylic

85% ABS: Acrylantril Butadine Styrene